

Fresh Meat, Deli and Fish Merchandiser

PARTS LIST

Item No.	Quantity	Description	
1.	1	Gasket 1 1/2 x 1/2 x 146	
2.	1	Silicone	
3.	1	Top Gasket Pad	
4.	1	Rail Light Joining Bracket	
5.	1	Joining Plate	
6.	4	Truss Head S METAL Screw 8 -18 x 3/8	
7.	1	Cap Screw Hex HD 5/16 - 18 x 2 1/2	Front
8.	2	Flat Washer 5/16	
9.	1	Lock Washer 5/16	
10.	1	Hex Nut 5/16 - 18	
11.	4	Spacer	Rear
12.	2	Cap Screw Hex HD 5/16 - 18 x 3 1/2	
13.	4	Flat Washer 5/16	
14.	2	Lock Washer 5/16	
15.	2	Hex Nut 5/16 - 18	
16.	1	Cap Screw 5/16 - 18 x 5 1/2	Top
17.	2	Flat Washer 5/16	
18.	1	Lock Washer 5/16	
19.	1	Hex Nut 5/16 - 18	
20.	5	Cap Plug	
21.	1	Splashguard Joint Plate	
22.	2	Splashguard Retainers	
23.	4	Hex Head Sheet metal Screw #8 x 1/2	



**Level
cases are
critical
for joining
and glass
alignment!**

NOTE: Be sure merchandisers have been leveled according to the installation instructions. Carefully unpack and inspect the Joining Kit, making sure there is no breakage or damage.



CAUTION

DO NOT remove riders until case is in its final position.

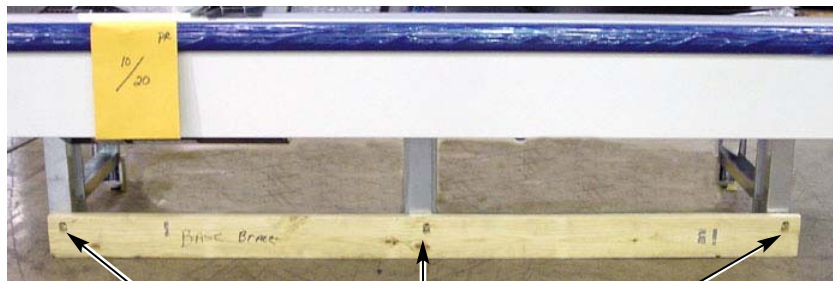

Remove Bolts from Front



- 1** Remove items below:
- A. Shelves if installed,
 - B. Display Pans,
 - C. Rear Pan Bracket,
 - D. Rear Panel and Discharge Grille
 - E. Front Return Air Grille from case.
- See Figure 1.

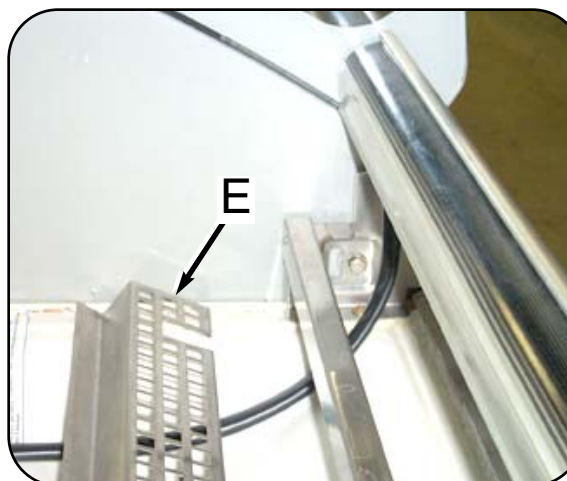
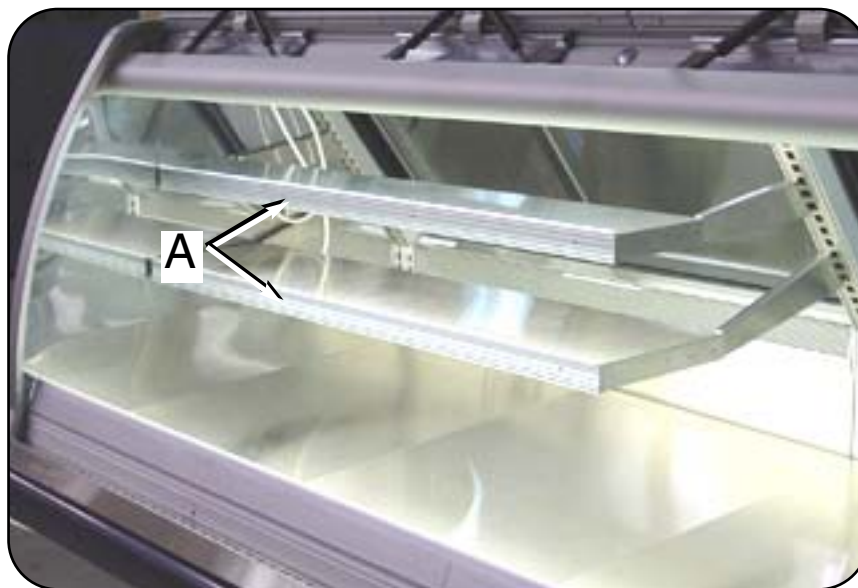

Figure 1. Removing items from case

GASKETING AND SEALING PROCEDURE

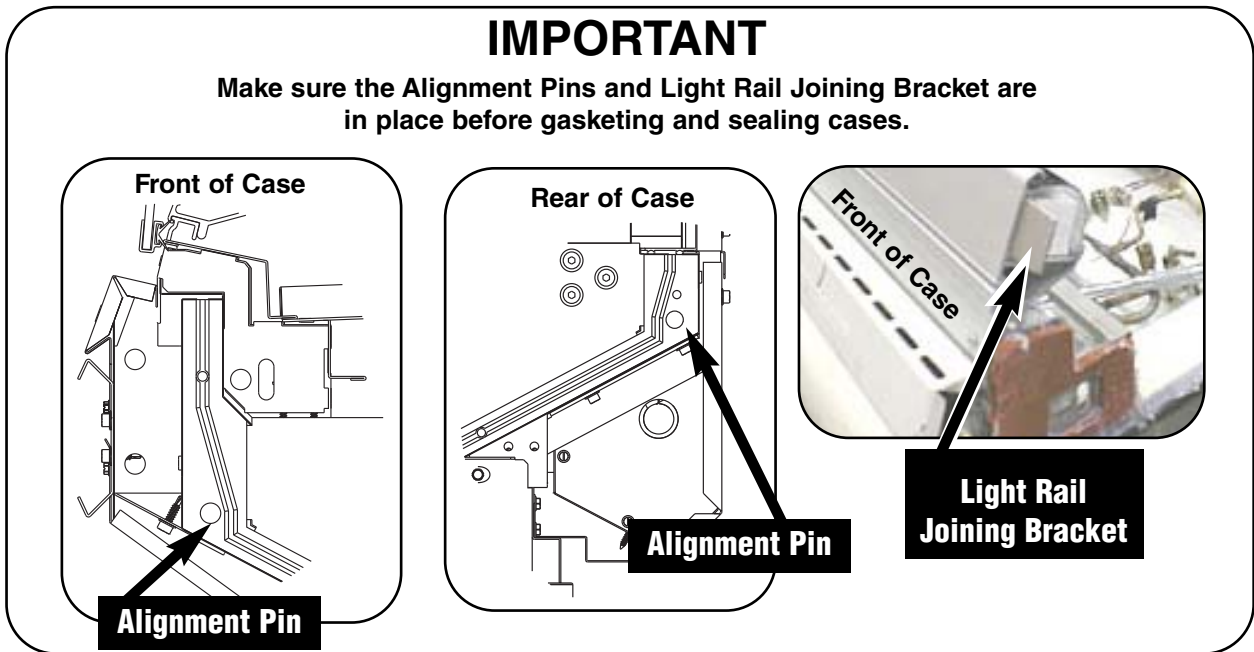

Figure 2. Install Alignment Pins and Light Rail Joining Bracket

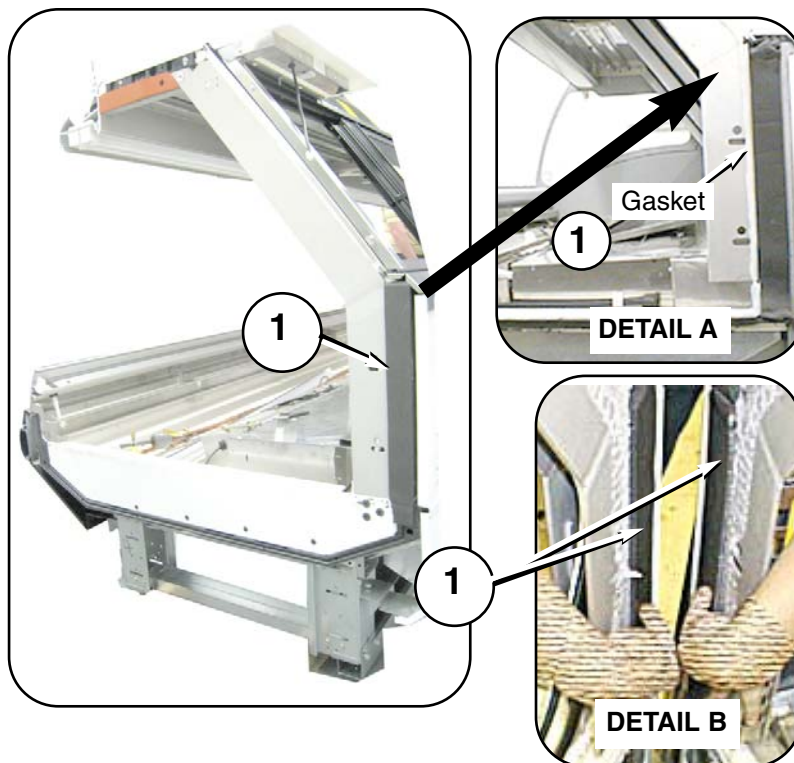

Figure 3. Applying 1 1/2 in. Gaskets to both cases.

2 Install the front and rear alignment pins in the locations shown below.

3 Apply 1 1/2 in. (38 mm) **Gasket (Item – 1)** to rear foam panel of both cases as shown. Check to be sure that there are no gaps between gasket and merchandiser.

- Do not stretch gasket.
- Do not butt gaskets.
- Remove paper backing after gasket has been applied.

GASKET MUST BE APPLIED TO BOTH CASES.

See Figure 3. Detail A and B.

4 Before joining, make sure to lay a 1/2 inch bead of clear **Silicone (Item – 2)** along the entire perimeter of the case as shown in **Figure 4**.

5 In addition, apply silicone around the perimeter of the front joining hole and over the top of the frame. See **Figure 4, Details C and D**.

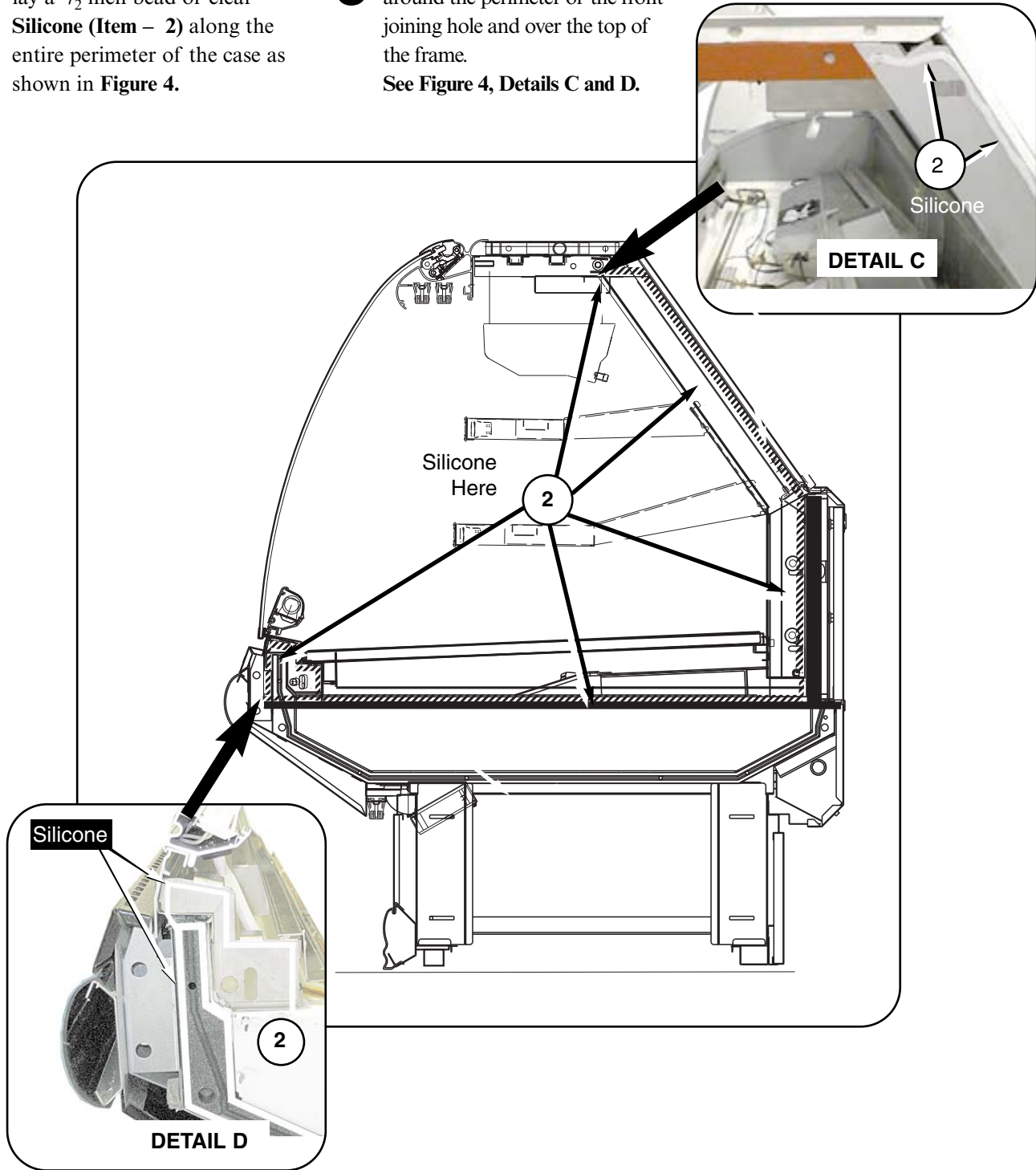

Figure 4. Applying Silicone

6 Install the **Top Gasket Pad**, (Item – 3).
See Figure 5, Detail E.

7 Apply Silicone along perimeter of merchandiser as shown in Figure 6. Be sure to apply silicone to the **Top Gasket Pad** (Item – 3). See Detail F.

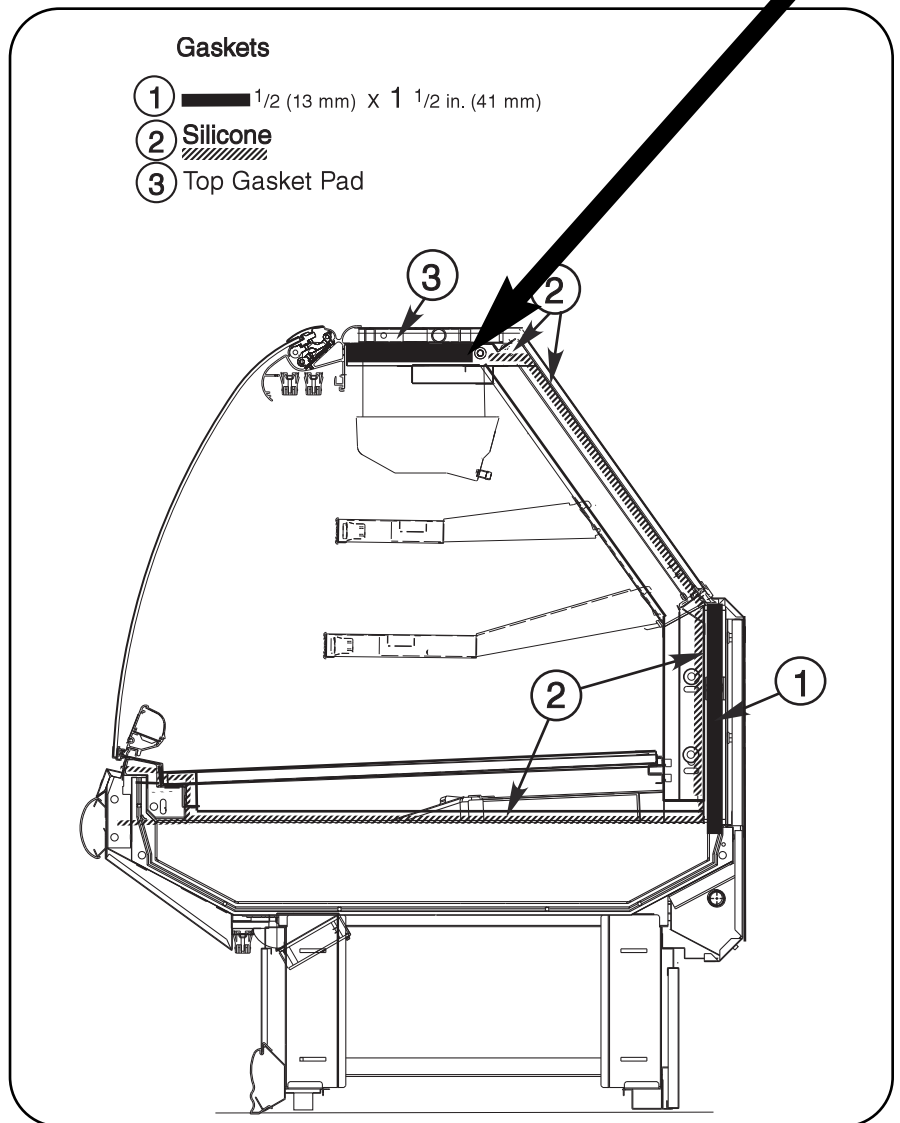
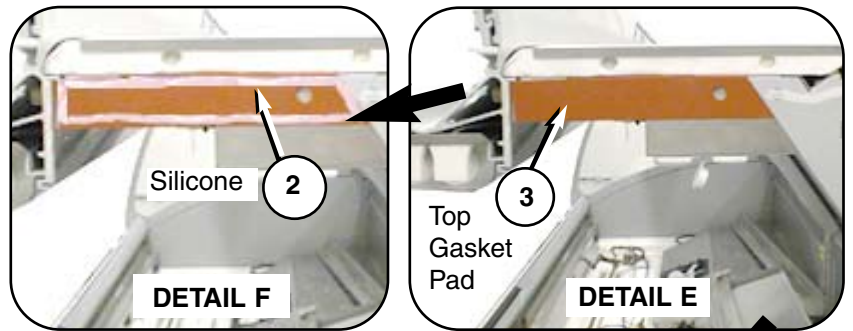

Figure 5. Applying Gasket Pad

8 Move the second merchandiser into position against the first. Match the alignment pins with the corresponding holes. See **Figure 6, Detail G**.

9 The complete lineup must be leveled to the highest point of the floor. After the first merchandiser has been set, position the second so the end frames touch.

A. Set a long level (4 foot or more) on the upper front panel of the merchandisers. Adjust case height by inserting shims until the merchandisers are flush and level. See **Figure 6**.

B. Check each joint area to be sure that the panels of adjoining merchandisers are flush to each other.

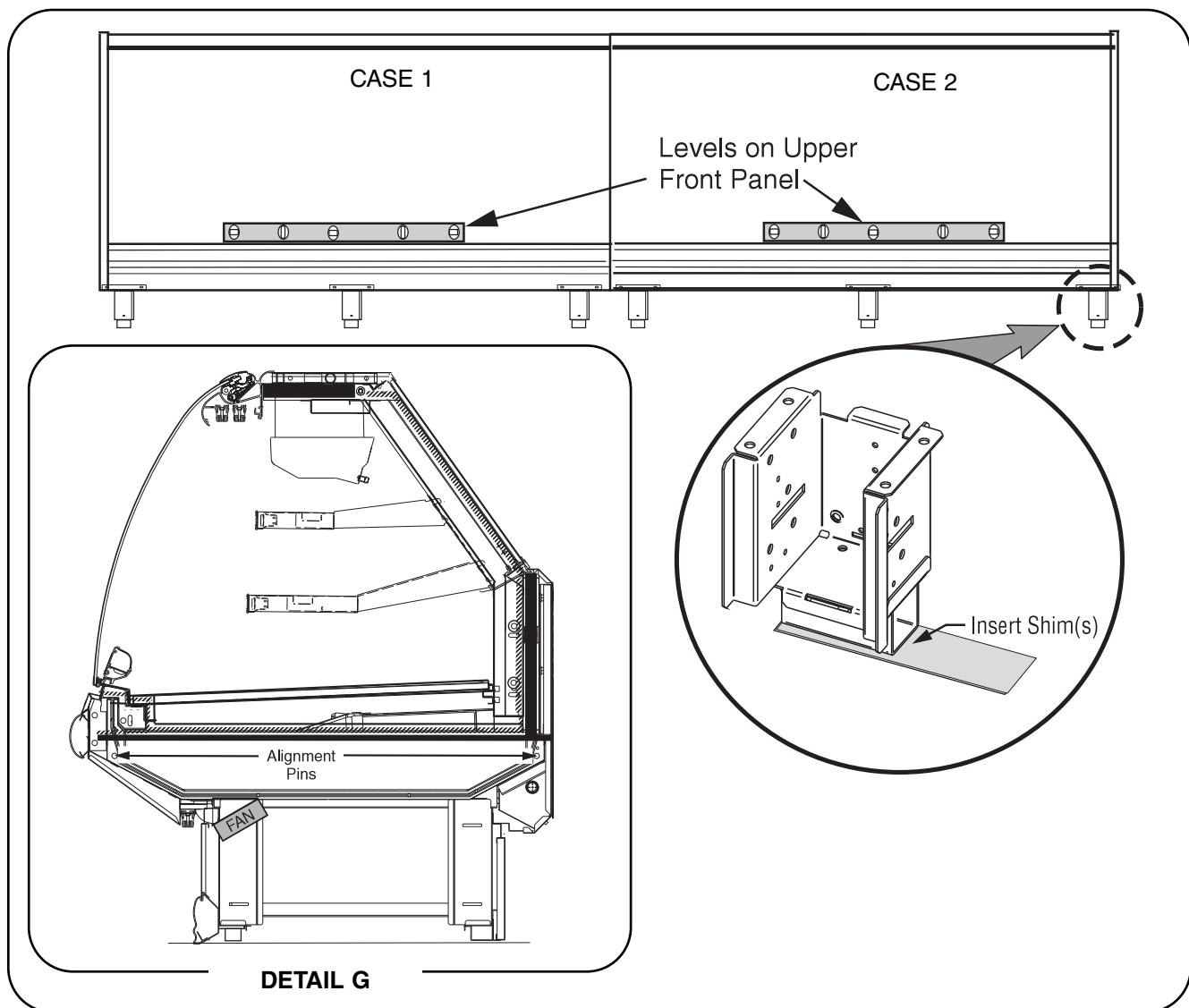

Figure 6. Leveling Merchandisers

10 Slide the **Rail Light Joining Bracket (Item – 4)** across both light channel extrusions to align the light rails.
See **Figure 7**.

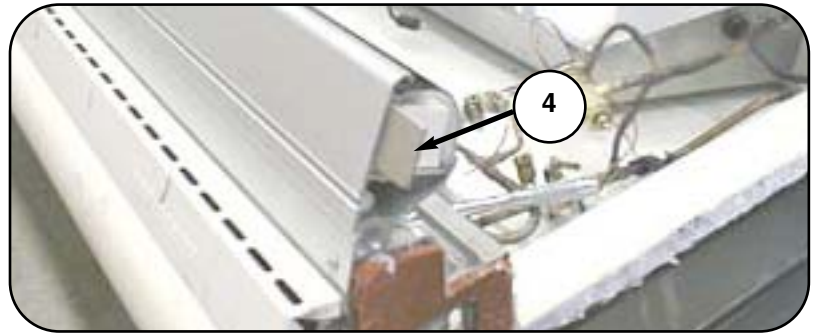

Figure 7. Front Rail Light Joining Plate

11 Align the top extrusion and insert **Joining Plate (Item – 5)**. Use **#8 Screws — 6** to fasten the plate using the pre-drilled pilot holes as shown in **Figures 8 and 9**.

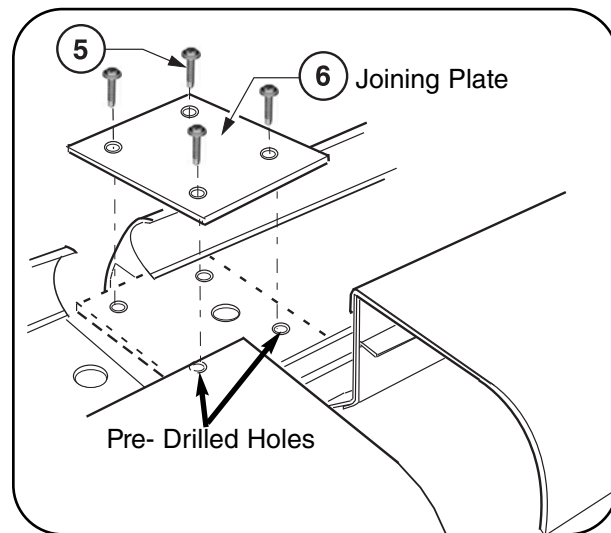

Figure 8. Installing Joining Plate

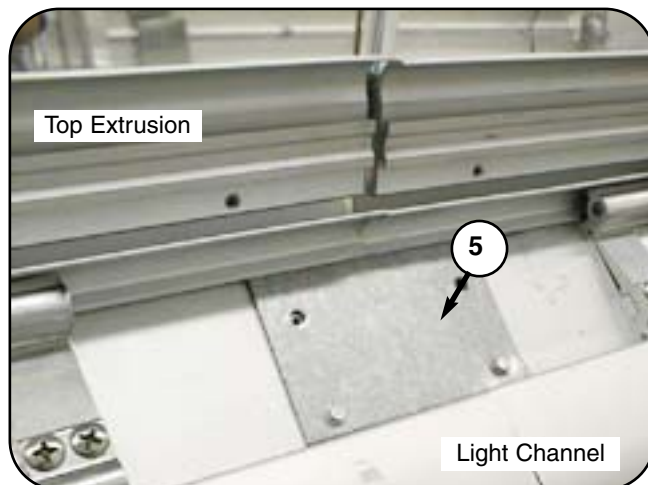

Figure 9. Joining Plate in Place

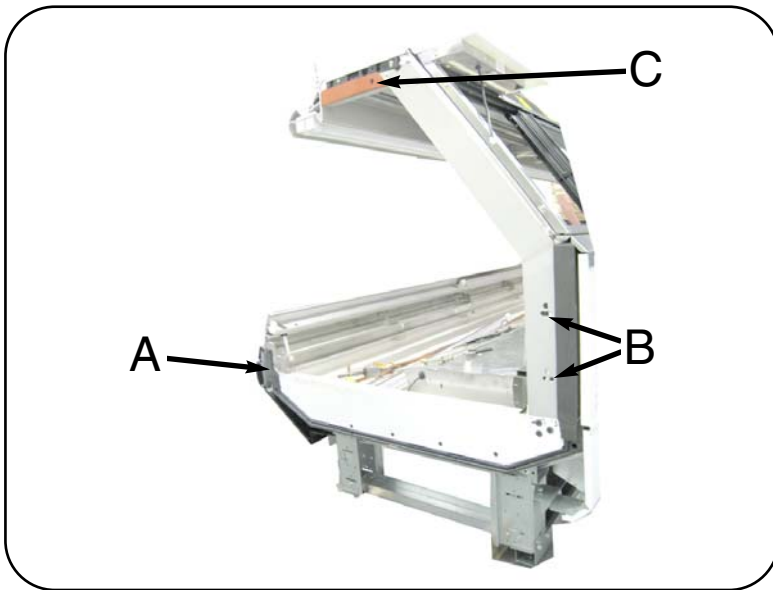

Figure 10. Fastening Sequence

12 Follow the fastening sequence when joining the cases: front, back, canopy.

See Figure 10.

Note: Make sure that not more than (2) threads are exposed when the cases are joined together. If this does occur, the bolt must be shortened, replaced with a shorter bolt or capped off according to NSF specifications.

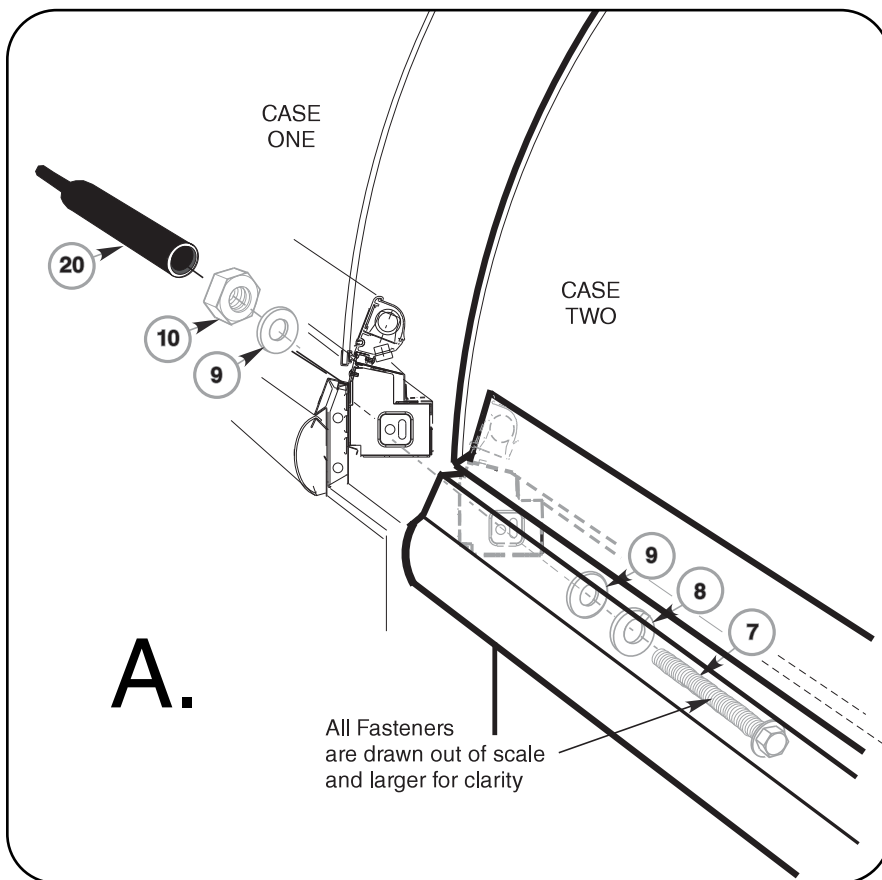

Figure 11. Fastening Front of Cases Together (Sequence A)

13 Fasten the fronts together using the following:
Cap Screws (Item –7),
Flat Washers (Item – 8),
Lock Washers (Item – 9),
Hex Nut (Item – 10) and
Cap Plug (Item – 20).
 See Figure 11.

- 14** Fasten the rear of the cases together at two locations shown below using, Spacers (Item – 11), Cap Screws (Item – 12), Flat Washers (Item – 13), Lock Washers (Item – 14) and Hex Nut (Item – 15). See Figure 12. Detail H.

! WARNING
Use caution when installing fasteners around wiring or refrigeration lines inside of struts.

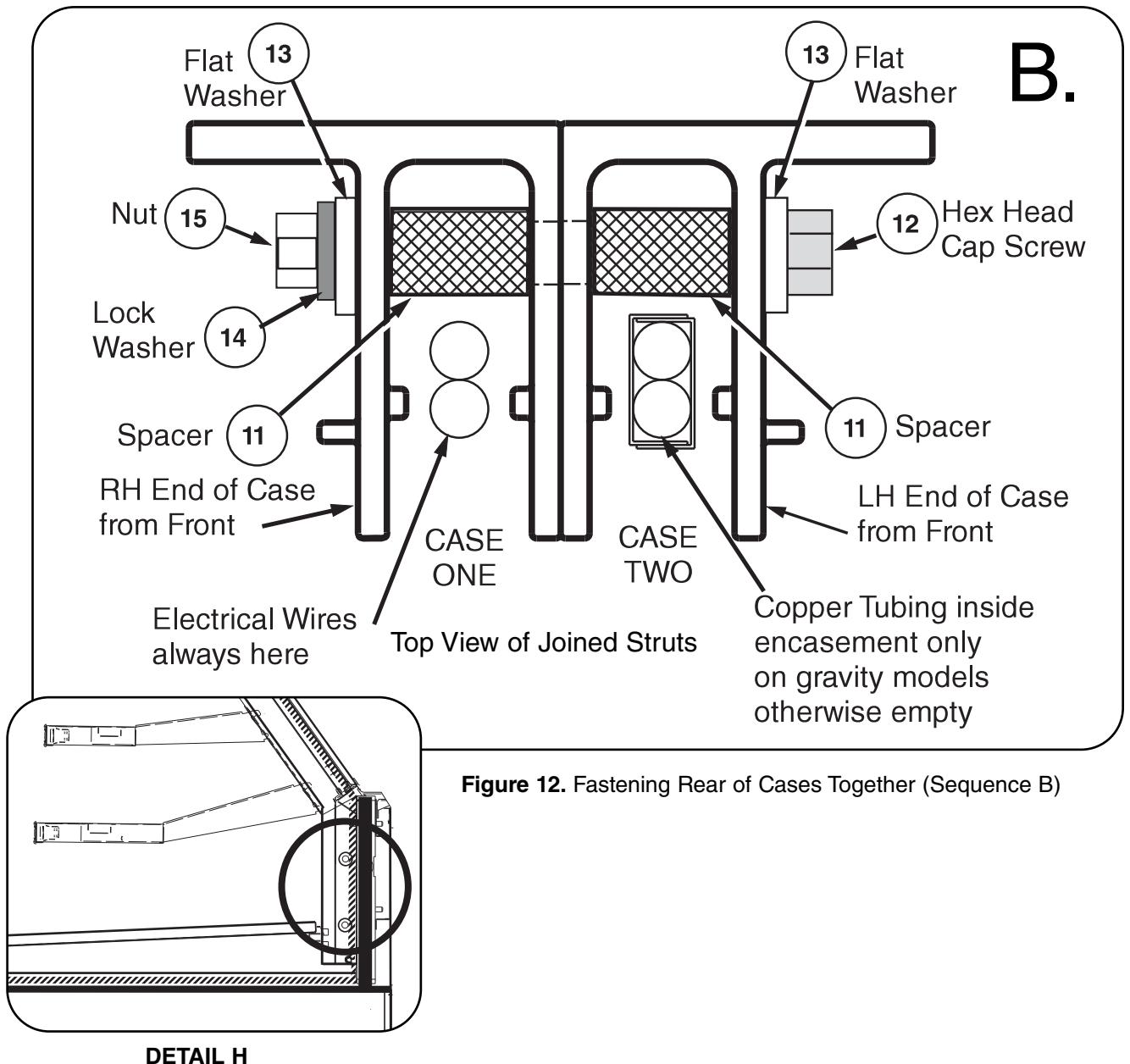

Figure 12. Fastening Rear of Cases Together (Sequence B)

15 Fasten the top rear of the cases together using **Cap Screws (Item – 16)**, **Flat Washers (Item – 17)**, **Lock Washers (Item – 18)**, **Hex Nut (Item – 19)** and **Cap Plug (Item – 20)**. See **Figure 13**.

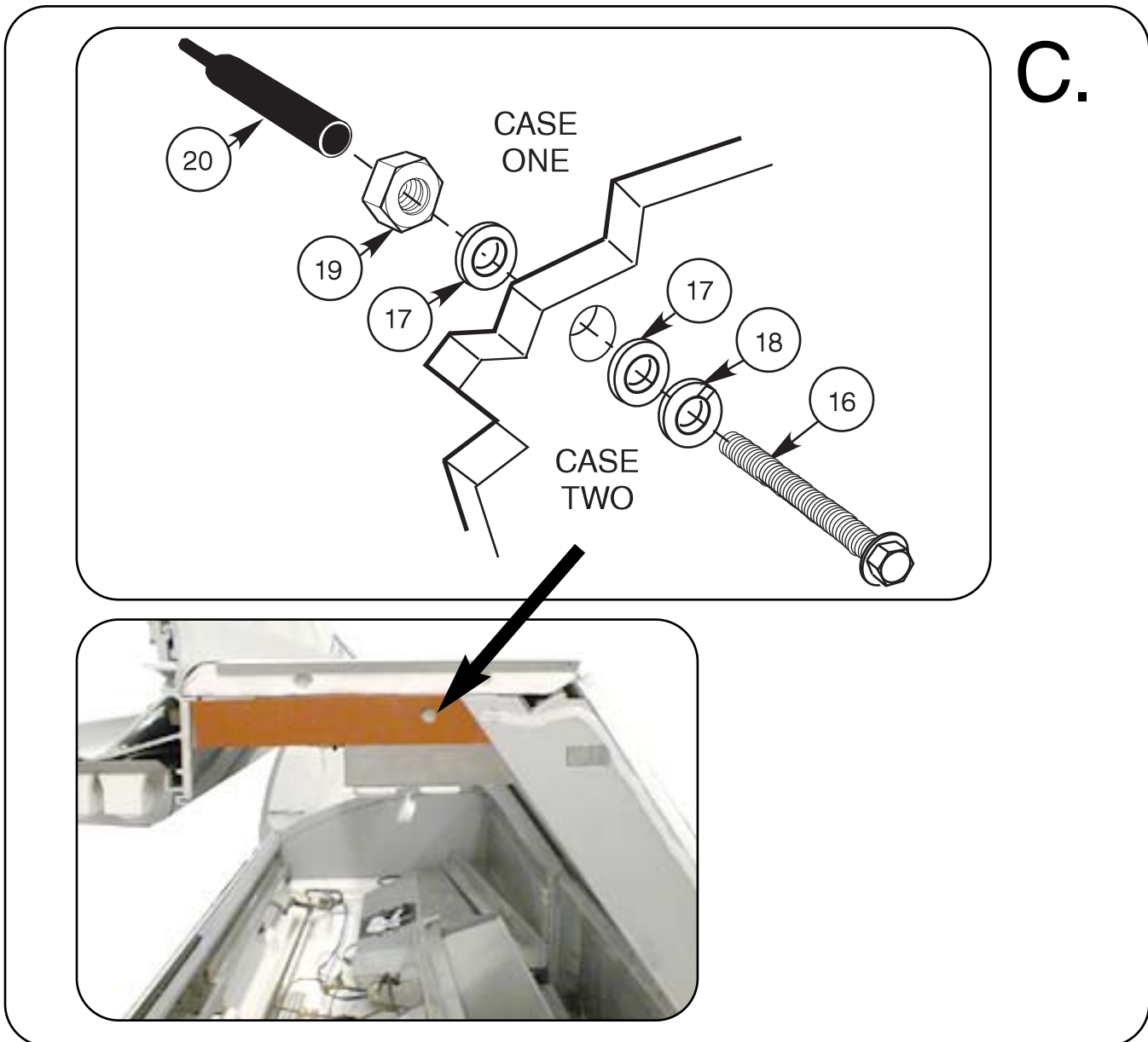

Figure 13. Fastening Top Fronts of Cases Together (Sequence C)

SEALING THE INTERIOR
BOTTOM OF THE CASES

- 16** Apply a continuous bead of **Silicone (Item – 2)** to the joint. Level and smooth the silicone so that there are no gaps or ridges in the case joint.

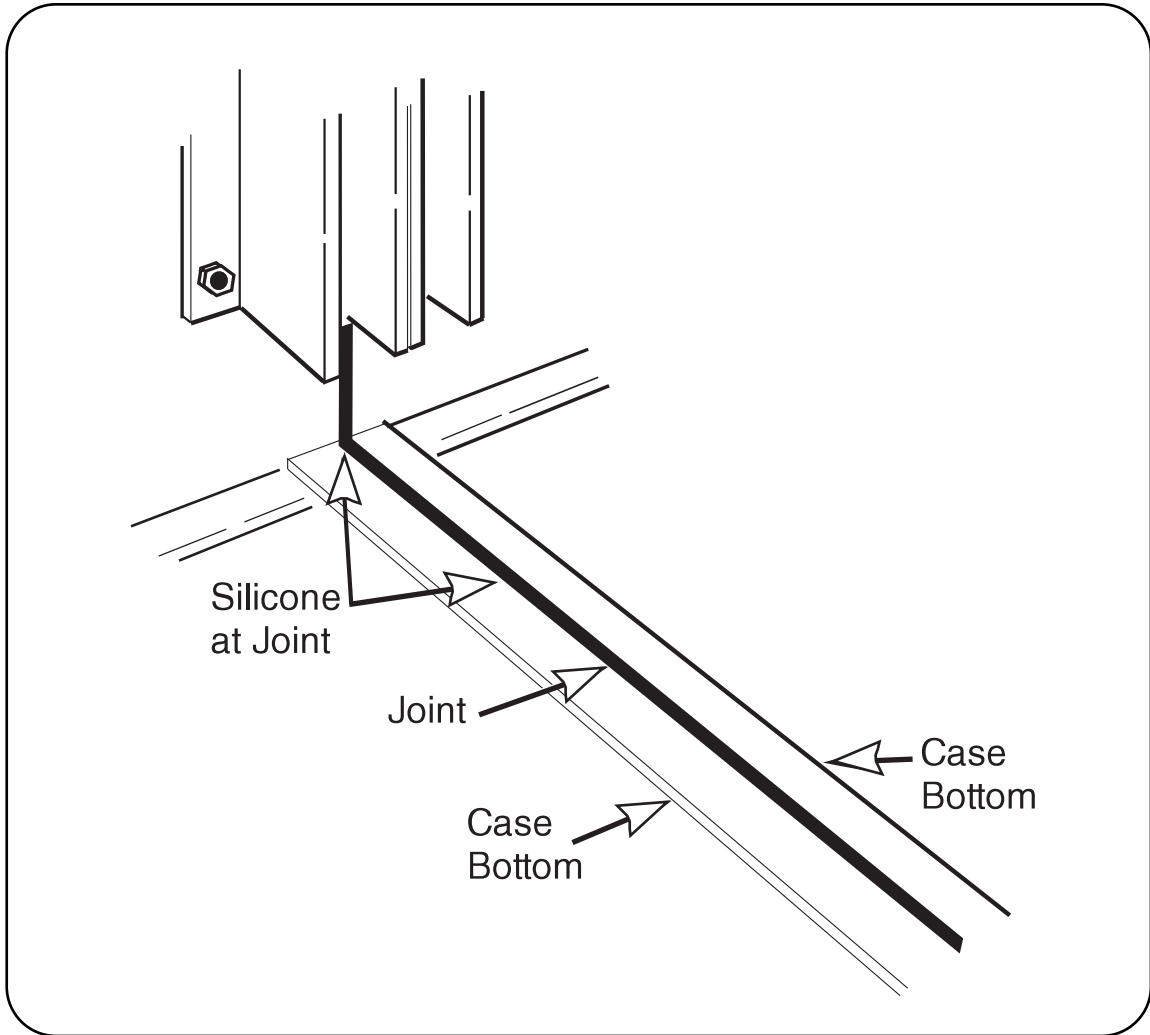

Figure 14. Installing and Sealing Joint Cover

SEALING THE EXTERIOR
OF THE CASE



17 Apply a smooth continuous bead of **Silicone (Item – 2)** over the **Exterior Top Joint** of the cases.



18 Continue sealing down the **Rear Mullion Joint** of the cases and finally seal the **Rear Sill Joints**, as shown in **Figure 15, A, B and C.**



Figure 15. Sealing Case Joints

INSTALLING
SPLASHGUARD

19 Attach the **Splashguard Joint Plate (Item – 21)**, and **Splashguard Retainers (Item – 22)** to the front side of the legs as shown using **Screws (Item – 23)**. See **Figure 16**.

After merchandisers have been leveled and joined, and all drip piping, electrical and refrigeration work has been completed, install the splashguard.

- Position top of splashguard over the top edge of the retainer/ bracket as shown in Detail I.
- Push the lower edge of the splashguard toward the bottom of the bracket until it snaps into place.

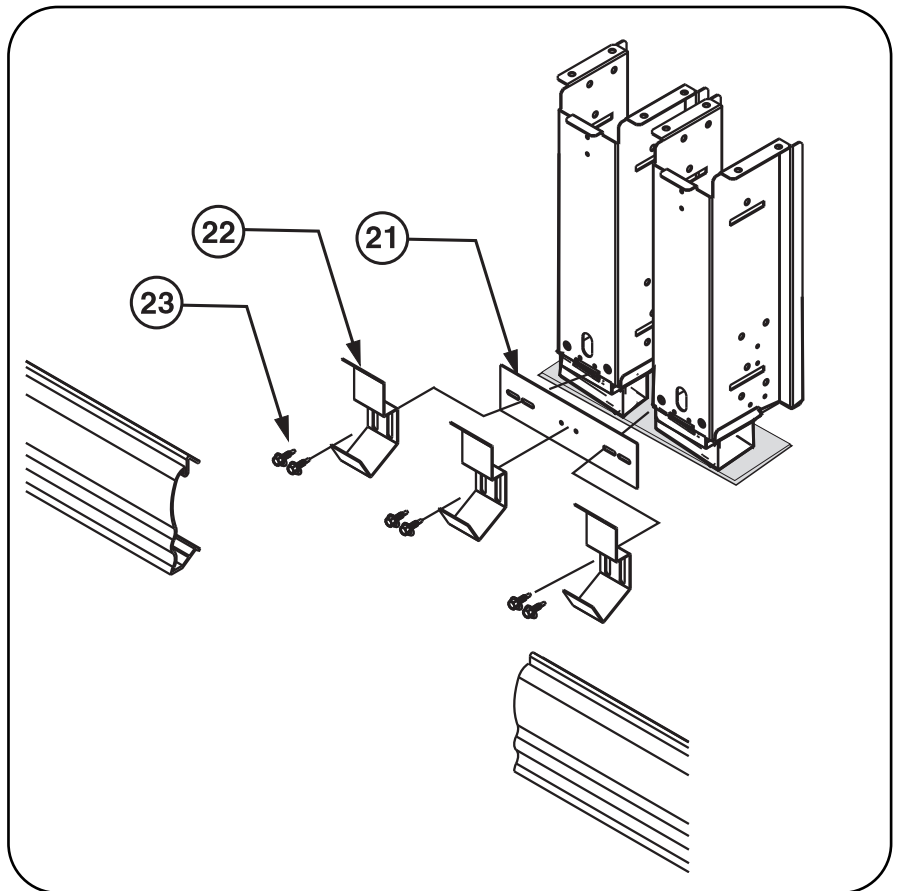

Figure 16. Installing Splashguard Retainers and Splashguard

