

HUSSMANN®

XtraLife™



ME5X-GP
 Technical Data Sheet
 P/N 0516007_B

NSF® Certified
 October 2011

DOE 2012
 Energy Efficiency
 Compliant

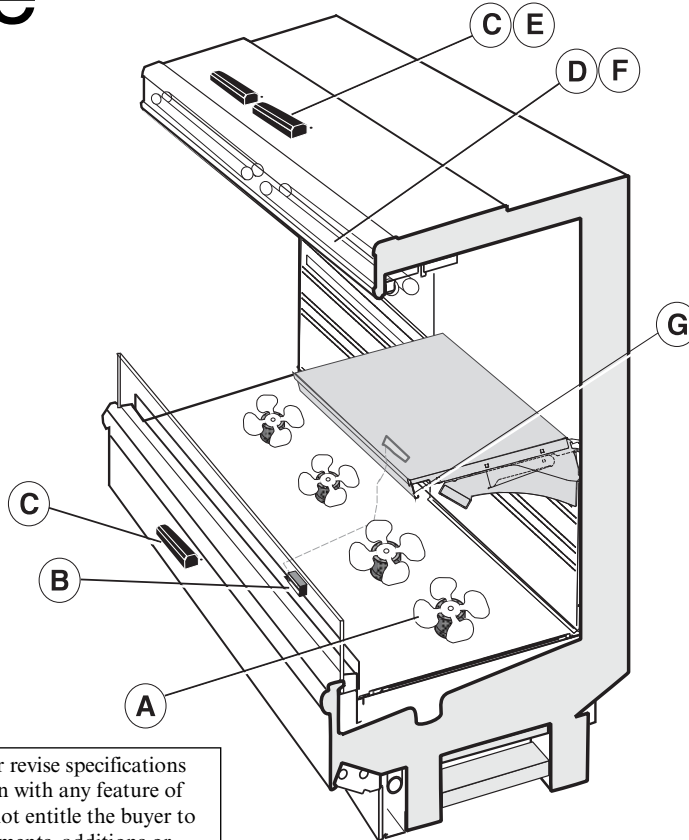

We reserve the right to change or revise specifications and product design in connection with any feature of our products. Such changes do not entitle the buyer to corresponding changes, improvements, additions or replacements for equipment previously sold or shipped.

Item	Part #	Description	Wiring Item #	Item	Part #	Description	Wiring Item #
FAN ASSEMBLIES				LAMPS AND BALLASTS			
<i>ONLY ENERGY EFFICIENT FANS ARE AVAILABLE</i>				C.		Ballast, Electronic	(3)
4 Ft, 8 Ft & 12 Ft					0480130	2 lamps (BA.4481676)	
A.		16W Energy Efficient Fan Assembly	(1)		0480131	3 lamps (BA.4481654)	
	0477657	Fan Motor, Evaporator (MO.4410546)			0480132	4 lamps (BA.4481677)	
	0461805	Fan Blade (FB.4780446)		D.		Fluorescent Lamp	(4)
						<i>Replace with like fixtures</i>	
6 Ft Only				LED FIXTURES AND POWER SUPPLY			
A.		12W Energy Efficient Fan Assembly	(1)	E.	0501213	Power Supply (EP.4481861)	(5)
	0477655	Fan Motor, Evaporator (MO.4410546)		F.		LED Canopy Fixture	(6)
	0463643	Fan Blade (FB.4780648)				<i>Replace with like fixtures</i>	
THERMOSTATS				G.		LED Shelf Fixture	(7)
B.		Optional Adjustable Refrigeration Thermostat(2)				<i>Replace with like fixtures</i>	

NOTE: For LED lighting parts contact your Hussmann service representative at 1-800-922-1919. Please have your model and serial number available. Descriptions including size and color are at WWW.HUSSMANN.COM/SERVICEANDPARTS.

Note: Revision B adds DOE 2012 compliance. Other changes marked by bar, underline or circle.



Engineering Plan Views

Meat and Produce

05-2010

PHYSICAL DATA

Merchandiser Drip Pipe (in.)	1 1/4
Merchandiser Liquid Line (in.)	3/8
Merchandiser Suction Line (in.)	7/8

ME5X

Dimensions shown as inches and (mm).

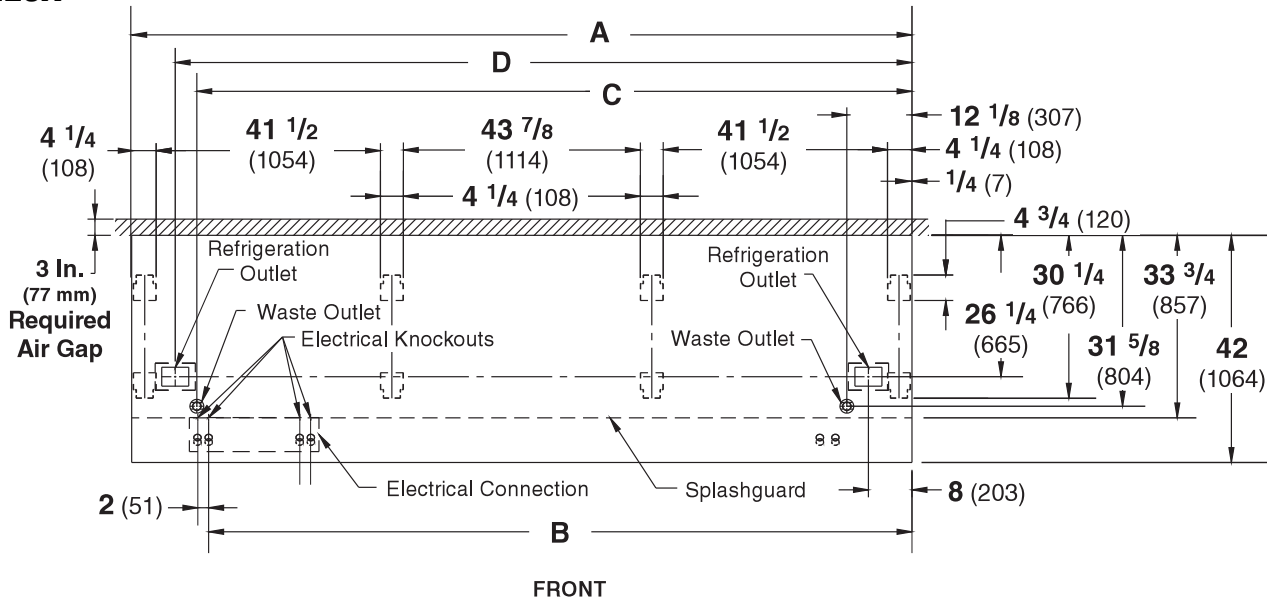

	6 ft	8 ft	10 ft	12 ft
General				
(A) Case Length (<i>without ends or partitions</i>) (Each end and insulated partition adds 1 1/2 in. (38 mm) to case line up.)	72 3/8 (1838)	96 3/8 (2448)	120 1/2 (3061)	144 1/2 (3670)
Maximum O/S dimension of case back to front (includes bumper)	42 (1064)	42 (1064)	42 (1064)	42 (1064)
Back of case to front of splashguard	33 1/2 (851)	33 1/2 (851)	33 1/2 (851)	33 1/2 (851)
Back of case to O/S edge of front leg	30 1/4 (768)	30 1/4 (768)	30 1/4 (768)	30 1/4 (768)
Distance between edges of external legs and center legs	29 1/2 (750)	41 1/2 (1054)	29 1/2 (749)	41 1/2 (1054)
Distance between edges of center legs	NA	NA	43 7/8 (1114)	43 7/8 (1114)
Distance between front legs and splashguard	2 3/4 (70)	2 3/4 (70)	2 3/4 (70)	2 3/4 (70)
Electrical Service <input type="checkbox"/> (<i>Electrical Field Wiring connection point</i>)				
(B) RH End of case to center of stub up area	60 1/4 (1530)	84 1/4 (2140)	108 1/4 (2750)	132 3/8 (3363)
Back of case to center of stub up area	24 (612)	24 (612)	24 (612)	24 (612)
Length of electrical wireway <input type="checkbox"/> Wireway	26 1/2 (673)	26 1/2 (673)	26 1/2 (673)	26 1/2 (673)
(C) RH End of case to LH end of wireway	66 1/8 (1680)	90 1/8 (2289)	114 1/4 (2902)	138 1/4 (3511)
Waste Outlets (<i>One each end</i>) <input checked="" type="checkbox"/>				
(D) RH End of case to the center of LH waste outlet	60 1/4 (1530)	84 1/4 (2140)	108 1/4 (2750)	132 3/8 (3363)
RH End of case to the center of RH waste outlet	12 1/8 (307)	12 1/8 (307)	12 1/8 (307)	12 1/8 (307)
Back O/S of case to center of waste outlets	31 5/8 (804)	31 5/8 (804)	31 5/8 (804)	31 5/8 (804)
Schedule 40 PVC drip pipe	1 1/4 (32)	1 1/4 (32)	1 1/4 (32)	1 1/4 (32)
Refrigeration Outlet <input type="checkbox"/>				
Back of case to center of refrigeration outlet	26 1/4 (665)	26 1/4 (665)	26 1/4 (665)	26 1/4 (665)
RH end of case to center of refrigeration outlet	8 (203)	8 (203)	8 (203)	8 (203)



Husmann refrigerated merchandisers configured for sale for use in the United States meet or surpass the requirements of the DOE 2012 energy efficiency standards.



REFRIGERATION DATA

Note: This data is based on store temperature and humidity that does not exceed 75°F and 55% R.H.

ME5X-GP	OPTIMAL SHELF LIFE		AHRI 1200 RATING POINT†	
	UNLIT	LIT	UNLIT	LIT
Discharge Air °F	29	27	37	35
Evaporator °F	24	22	32	30
Unit Sizing °F	22	20	30	28
<i>Btu/hr/ft — Unlit Shelves‡</i>	Parallel	Conventional	Parallel	Conventional
	UNLIT	1150	1285	945

‡ Add 10 Btu/hr/ft *per shelf row* for LED fixtures.

† For energy consumption comparison only.

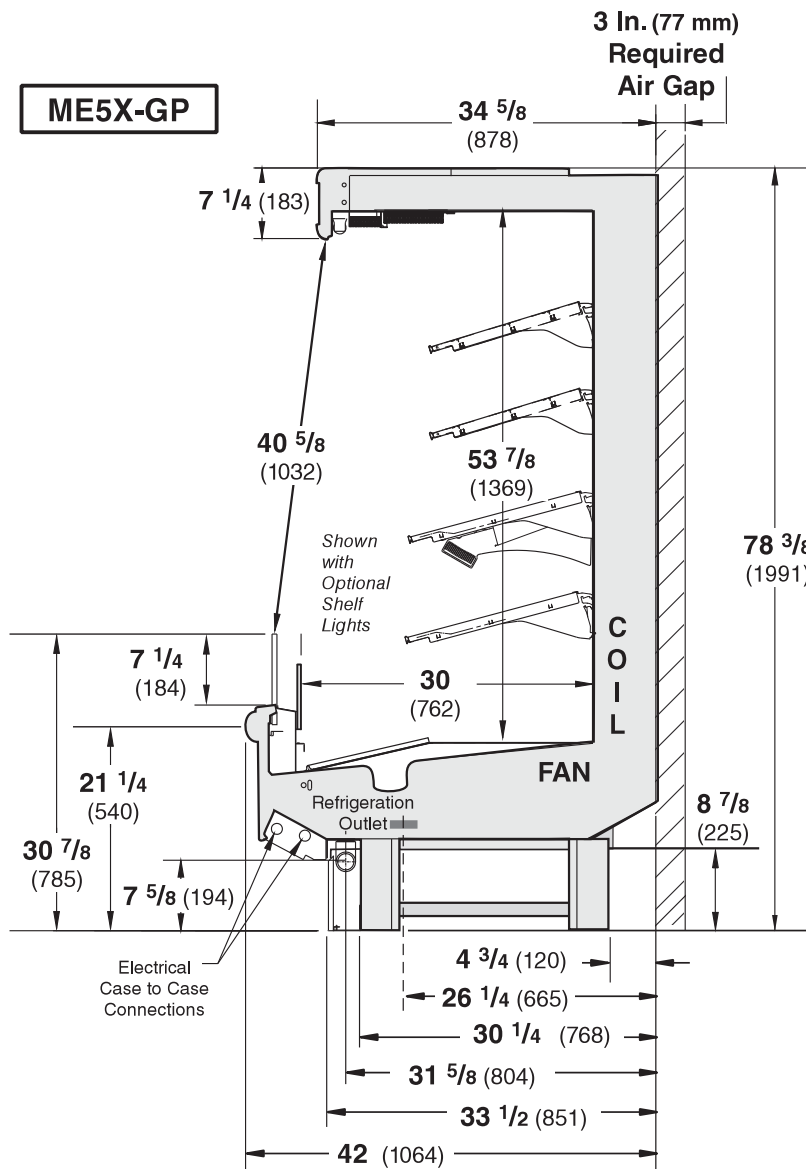

DEFROST DATA

Frequency Hr	4
Defrost Water (lb/ft/day)	9
(± 15% based on case configuration and product loading).	

<i>OFFTIME</i>	ME5X-GP
Time (minutes)	25
<i>ELECTRIC OR GAS</i>	Not Recommended

CONVENTIONAL CONTROLS

Low Pressure Backup Control	
ME5X-GP	
CIICO*	15°F / 5°F
Indoor Unit Only,	
Pressure Defrost Termination*	48°F
*Use a Temperature Pressure Chart to determine PSIG conversions.	

Estimated Charge**	ME5X-GP		
4ft	1.9 lb	30 oz	0.9 kg
6ft	2.5 lb	40 oz	1.1 kg
8ft	3.7 lb	59 oz	1.7 kg
12ft	5.1 lb	82 oz	2.3 kg

**This is an average for all refrigerant types. Actual refrigerant charge may vary by approximately half a pound (8 oz/0.2 kg).

NSF Certification

This merchandiser model is manufactured to meet NSF/ANSI (National Sanitation Foundation) Standard #7 requirements for construction, materials & cleanability.

Excel ME5X-GP

Extra Life Meat

Electrical Data

	4 ft	6 ft	8 ft	12 ft
Number of Fans – 16W	2	—	4	6
Number of Fans – 12W	—	4	—	—

	Amperes				Watts			
	4 ft	6 ft	8 ft	12 ft	4 ft	6 ft	8 ft	12 ft
Evaporator Fans								
120V 60Hz Standard Energy Efficient	0.8	1.2	1.6	2.4	60	72	120	180
120V 50Hz Standard Energy Efficient								
230V 60Hz Export	NA							
230V 50Hz Export	NA							

Minimum Circuit Ampacity

120V 60Hz Standard Energy Efficient	1.0	1.4	1.8	2.6
120V 50Hz Standard Energy Efficient				
230V 60Hz Export	NA			
230V 50Hz Export	NA			

Maximum Over Current Protection 120V

Maximum Over Current Protection 120V	20	20	20	20
Maximum Over Current Protection 230V	15	15	15	15

Standard Lighting (T-8 fluorescent)

1 Row Canopy	0.26	0.51	0.51	0.77	30	59	59	85
--------------	------	------	------	------	----	----	----	----

Optional Lighting (T-8 fluorescent)

Additional 1 Row Canopy	0.26	0.51	0.51	0.77	30	59	59	85
Additional 2 Row Canopy	0.51	1.02	1.02	1.54	59	118	118	170
Additional 3 Row Canopy	0.77	1.53	1.53	2.31	89	177	177	255
1 Row Rail Light	NA — Glass front does not accept rail light							

Fluorescent Shelf Lighting is not available on ExtraLife Merchandisers.

EcoShine Multi-deck Canopy Normal CRI — 120VAC, 50/60Hz

2 Row Canopy (Front & Rear)	0.28	0.41	0.55	0.82	33	49	66	98
3 Rows of Shelves	0.29	0.44	0.58	0.88	35	53	70	105
4 Rows of Shelves	0.39	0.58	0.78	1.17	47	70	93	140
5 Rows of Shelves	0.48	0.73	0.97	1.45	58	87	116	174

EcoShine Multi-deck Canopy High CRI — 120VAC, 50/60Hz

2 Row Canopy (Front & Rear)	0.32	0.47	0.63	0.93	38	56	75	112
3 Rows of Shelves	0.35	0.53	0.70	1.05	42	63	84	126
4 Rows of Shelves	0.47	0.70	0.93	1.40	56	84	112	168
5 Rows of Shelves	0.58	0.88	1.17	1.75	70	105	140	210

120V Lighting Circuit Total = Standard Lighting + Total Optional Lighting + Optional Shelf Lighting

230V Lighting Circuit Total = Multiply 120V Lighting Circuit Total by 0.52

Product Data

<i>Recommended Usable Cube</i> ¹ (Cu Ft/Ft)	6.95 ft ³ /ft (0.65 m ³ /m)
<i>AHRI Total Display Area</i> ² (Sq Ft/Ft)	4.40 ft ² /ft (1.34 m ² /m)
<i>Shelf Area</i> ³ (Sq Ft/Ft)	8.36 ft ² /ft (2.55 m ² /m)

- ¹ AHRI Refrigerated Volume less shelving and other unusable space: Refrigerated Volume/Unit of Length, ft³/ft [m³/m]
² Computed using AHRI 1200 standard methodology: Total Display Area, ft² [m²]/Unit of Length, ft [m]
³ Shelf surface area is composed of bottom deck plus standard shelf complement, as shown in the Hussmann *Product Reference Guide*. The standard shelf complement for this model is (2) rows of 16-inch shelves and (2) rows of 18-inch shelves.

ESTIMATED SHIPPING WEIGHT ⁴

Case					Solid End
	<i>6 ft</i>	<i>8 ft</i>	<i>10 ft</i>	<i>12 ft</i>	<i>(each)</i>
lb (kg)	1000 (454)	1100 (499)	1300 (590)	1500 (680)	100 (45)

⁴ Actual weights will vary according to optional kits included.

Fan Wiring Offtime Defrost

2, 4 & 6 Fans

4 ft — 2 Fan
6 ft — 4 Fans
8 ft — 4 Fans
12 ft — 6 Fans

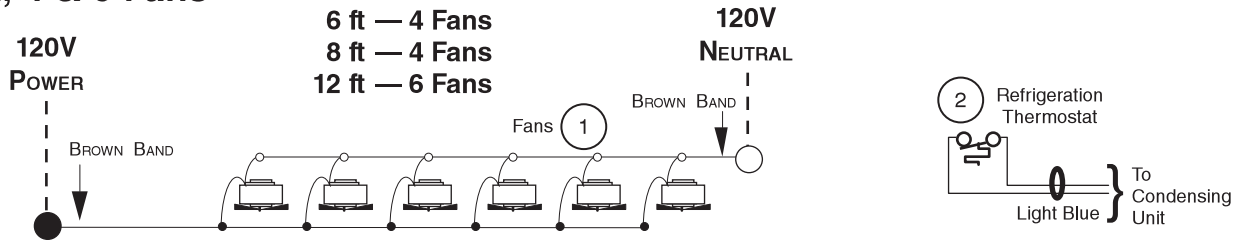

Light Circuits — Fluorescent Fixtures

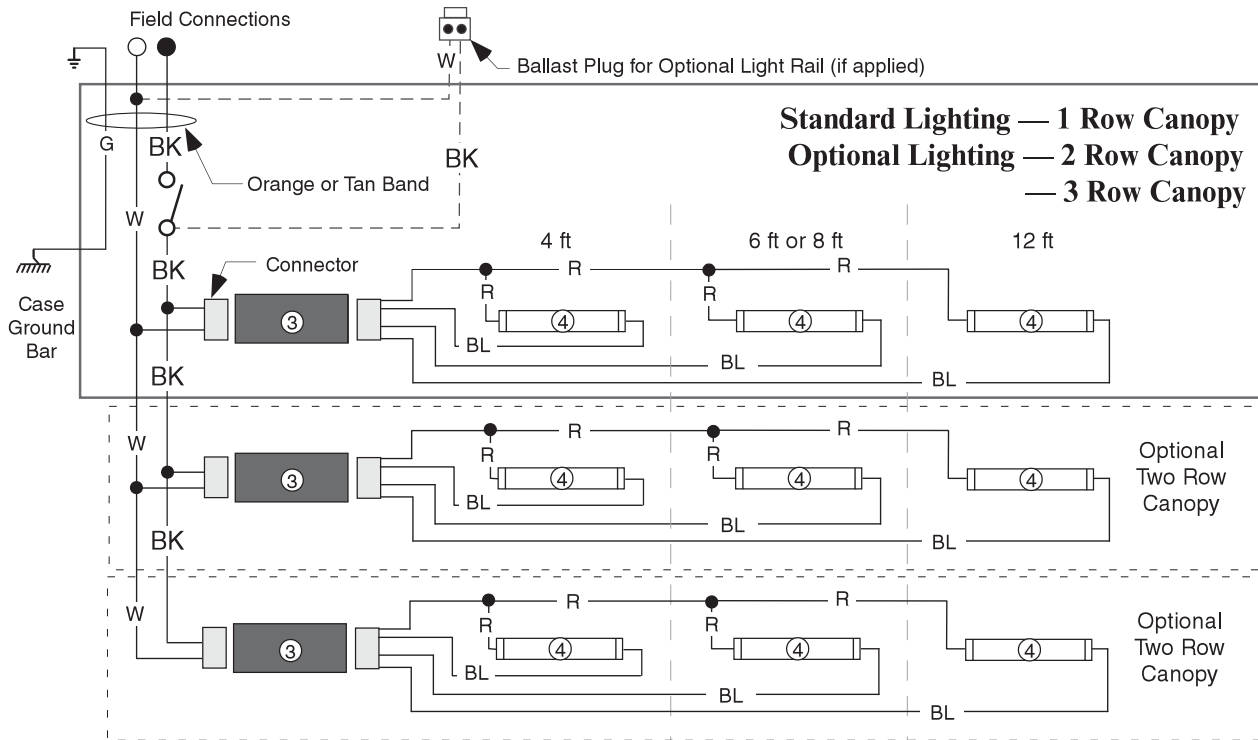

WARNING

All components must have mechanical ground, and the merchandiser must be grounded.

CIRCLED NUMBERS = PARTS LIST ITEM NUMBERS

R = Red Y = Yellow G = Green BL = Blue BK = Black W = White

● = 120V POWER ○ = 120V NEUTRAL ⊥ = FIELD GROUND ⏏ = CASE GROUND

Optional Canopy Lighting LED Fixtures

Standard LED Canopy Lighting — 2 Row Canopy

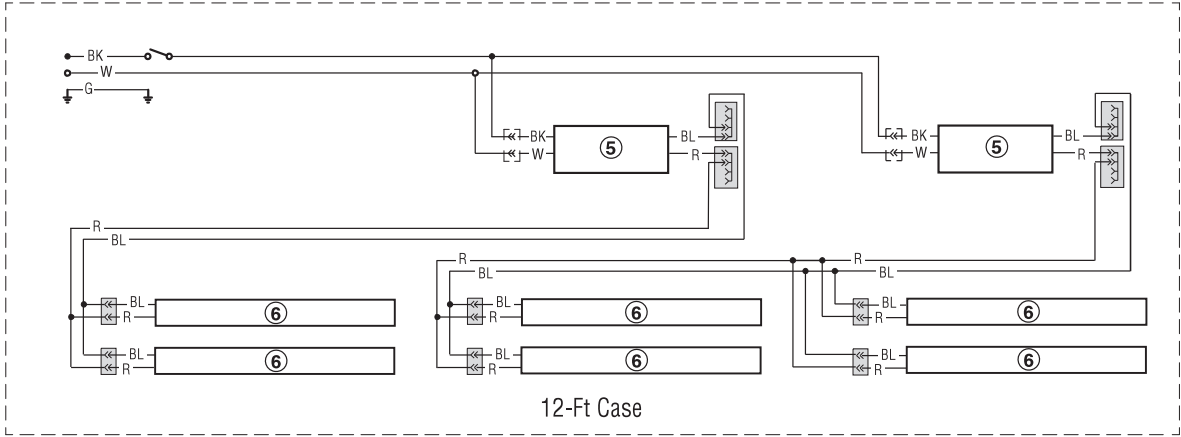
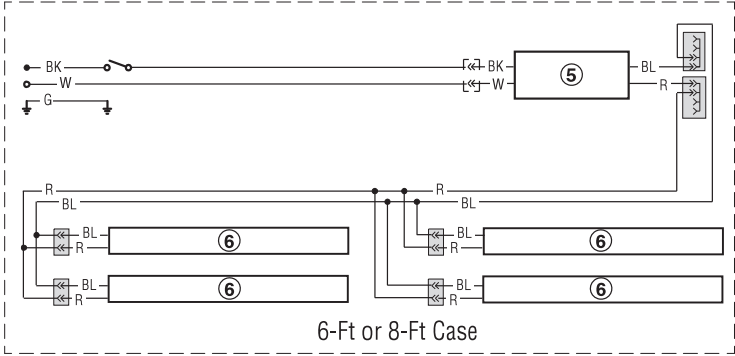
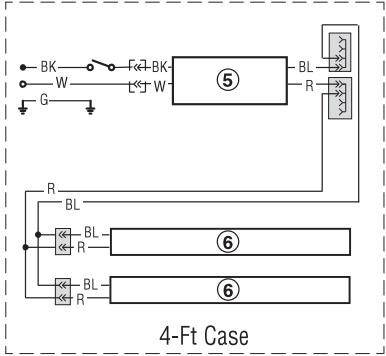

WARNING

All components must have mechanical ground, and the merchandiser must be grounded.

CIRCLED NUMBERS = PARTS LIST ITEM NUMBERS

R = Red Y = Yellow G = Green BL = Blue BK = Black W = White

● = 120V POWER ○ = 120V NEUTRAL ⊥ = FIELD GROUND ≡ = CASE GROUND

Optional Shelf Lighting LED Fixtures

Optional Shelf Harness and LED Light Circuits for 3, 4, 5, 6 & 7 Rows of Shelves

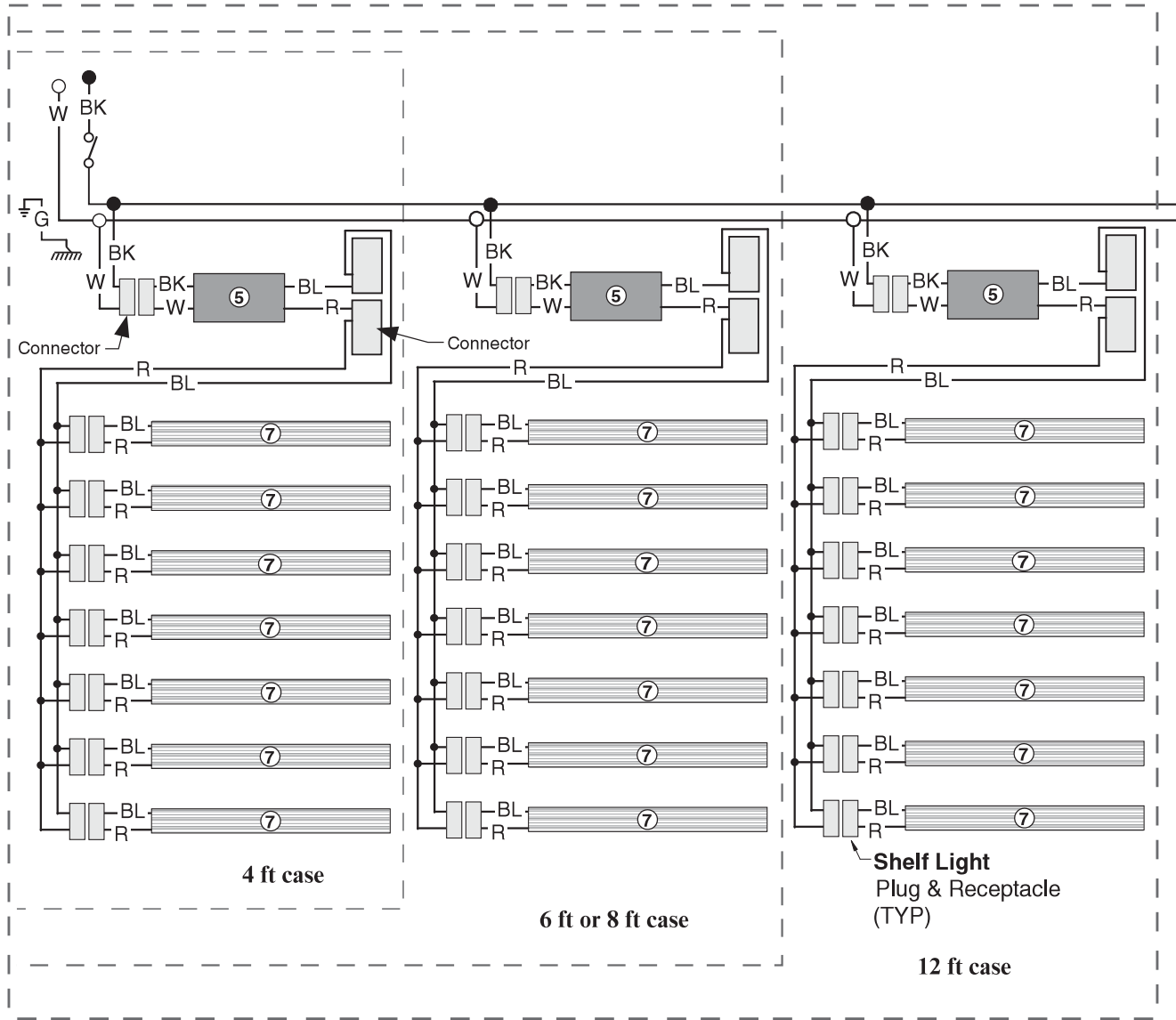

WARNING

All components must have mechanical ground, and the merchandiser must be grounded.

CIRCLED NUMBERS = PARTS LIST ITEM NUMBERS

R = Red

G = Green

BL = Blue

BK = Black

W = White

● = 120V POWER

○ = 120V NEUTRAL

⏏ = FIELD GROUND

mmm = CASE GROUND

SHELF CONFIGURATION

This merchandiser is designed for three, four, or five shelves.

Husmann recommends the top shelf be not more than 16-inches deep.

The Duct Shelf is easier to install if the duct assembly is inserted **AFTER** the Duct Shelf is installed.

The duct shelf must be installed at a 10- or 15-degree tilt with the bottom hook of each bracket inserted above slot 20 and below slot 23 (counting from the bottom of the interior back panel).

When properly installed, the duct will cover the large moiré pattern in the lower back panel. The duct is designed so that the shelf can move up or down within three positions and still cover the moiré pattern.

After sliding duct in completely, tabs at rear of shelf must be rotated downward to hold the duct in position.



An exploded view of the Duct Shelf Assembly is shown on the next page.

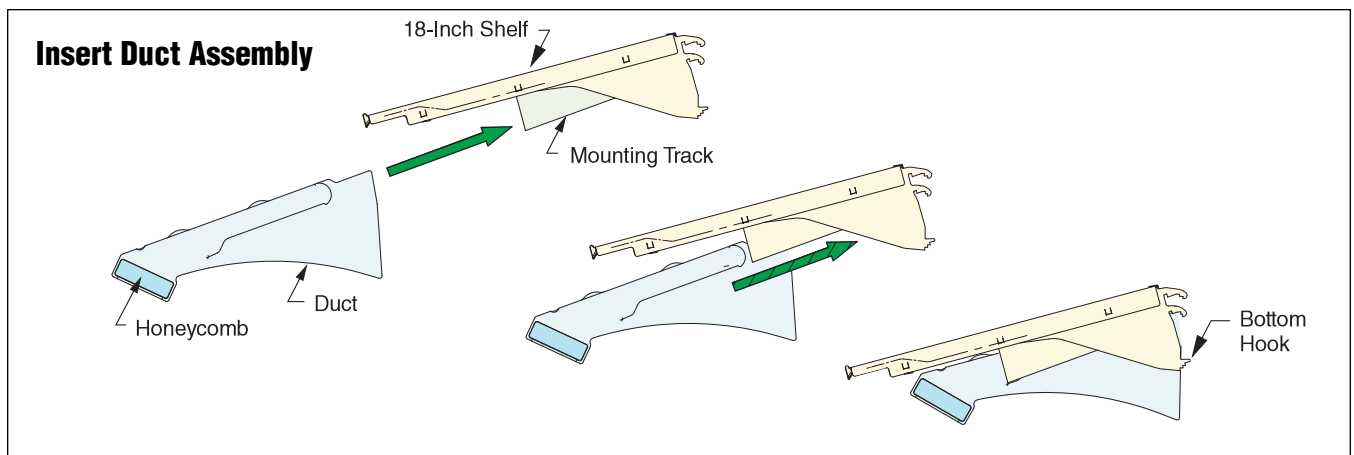
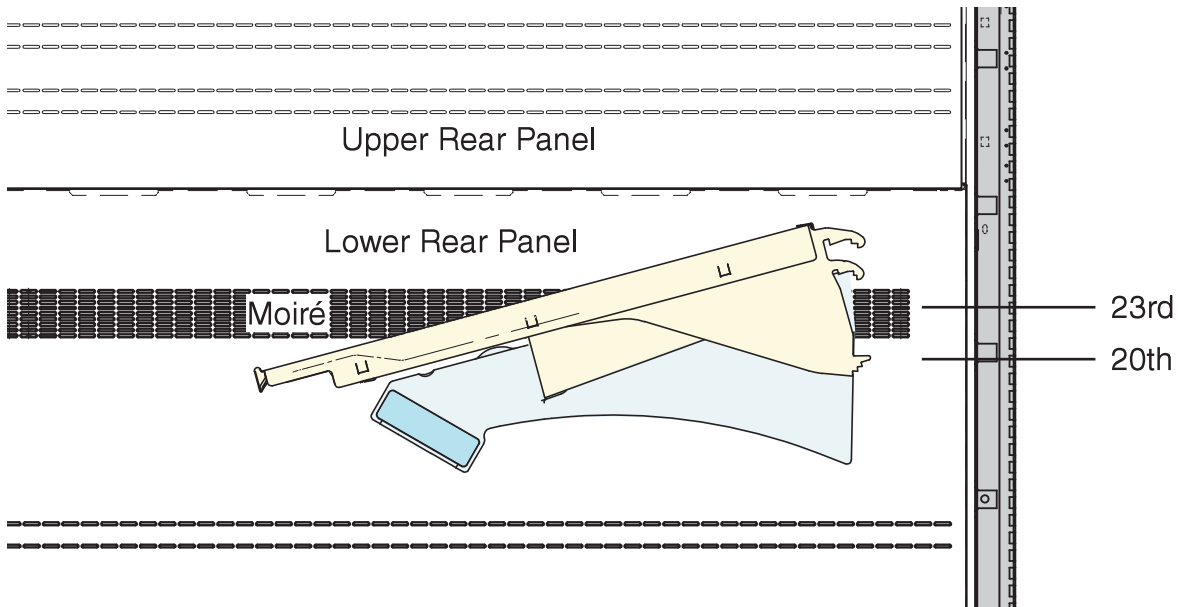

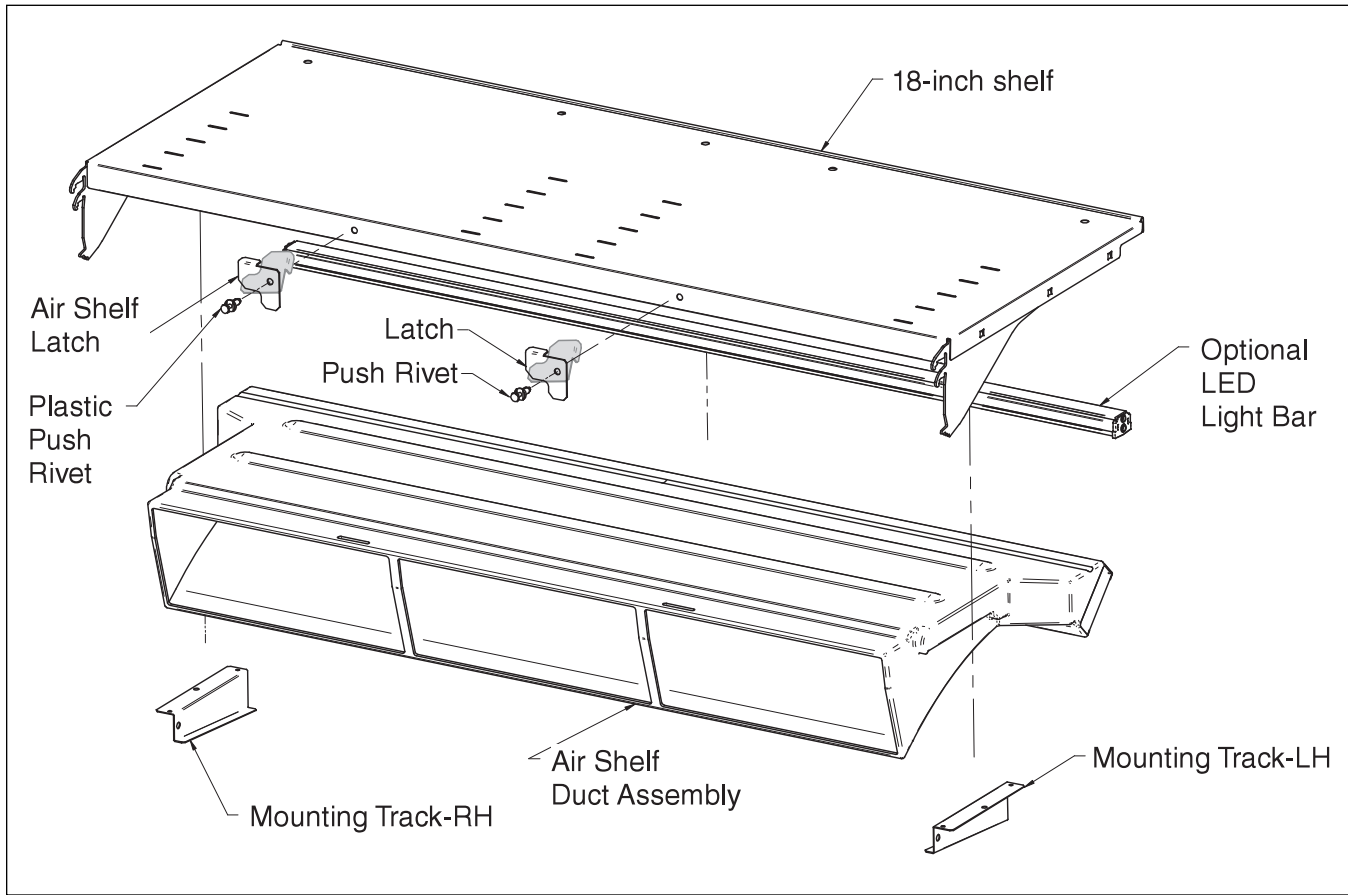

**Exploded View (Rear) of the
Air Shelf Duct Assembly**